

This plan has been drafted by PLANW3ST, an independent, experienced CPTED consultant.

It is understood that SAFETY AND SECURITY REVIEWS do not guarantee a crime will never occur; it is an effort to mitigate opportunities for crime and to help avoid any present and future security deficiencies, conflicts, threats, breaches, or liabilities that might occur without any review. It is further understood that all comments made by the Broward Sheriff's Office regarding this plan are preliminary only, as additional SECURITY STRENGTHENING AND CPTED attributes may be required as development progresses.

When a Broward Sheriff's Office CPTED Practitioner is required to assist in an inspection of the project during the Certificate of Completion &/or Certificate of Occupancy Application Phase, Security Strengthening & CPTED measures that have not been adequately addressed will still be required to ensure the safety & wellbeing of the employees, residents, tenants, visitors & all legitimate users of the site.

PROPOSED CAMERA, MONITORING, AND BSO NO TRESPASS SIGNAGE LOCATIONS WILL BE COORDINATED WITH A SECURITY AND ACCESS CONTROL CONSULTANT AS WELL AS THE BROWARD SHERIFF'S OFFICE CPTED REVIEWER \*\*\* PRIOR \*\*\* TO PERMITTING. PLANNING AND INSTALLATION OF THE SURVEILLANCE MONITORING SYSTEM AND SIGNAGE MUST INCLUDE FIELD INPUT FROM EXPERIENCED CPTED / SECURITY STRENGTHENING LAW-ENFORCEMENT TO ENSURE OPTIMAL RESULTS.

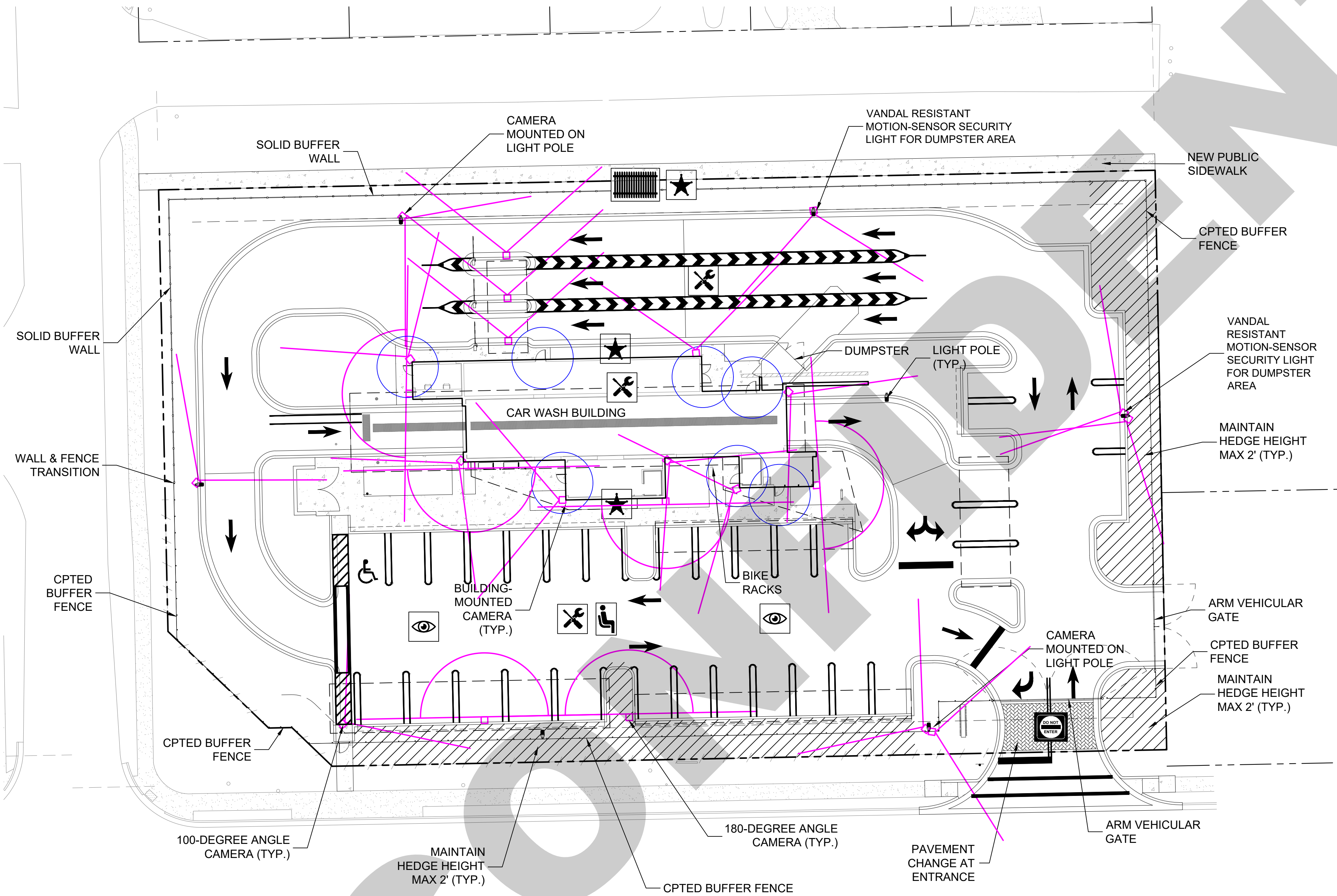
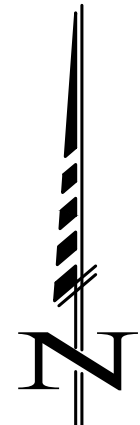

LEGEND	
SYMBOLS	CPTED & CRIME PREVENTION SECURITY PRINCIPLES
	NATURAL SURVEILLANCE
	MAINTENANCE
	TERRITORIAL REINFORCEMENT - SHERIFF NO TRESPASS PROGRAM
	TERRITORIAL REINFORCEMENT
	ACCESS CONTROL
	ACTIVITY SUPPORT
	CAMERA LOCATIONS
	BUILDING ENTRANCES

No.	Revision/Issue	Date
4	AAC SUBMITTAL	12/4/25
3	DRC RESUBMITTAL	10/29/25
2	DRC RESUBMITTAL	9/8/25
1	DRC SUBMITTAL	07/15/25



**PLANW3ST**  
10152 INDIANTOWN RD.  
# 159  
JUPITER, FL 33478  
954-529-9417  
planw3st.com

Project Name and Address

**RISING TIDE CAR WASH**  
  
W ATLANTIC BOULEVARD  
POMPANO BEACH FL, 33069

Project	2025-014	Sheet	PS-1
Date	7/2/2025		
Scale	1" = 20'		